

PORTER Standard Center Dowel Pilot Punches (CDSAP)

Center Dowel Angular Pilot-CDSAP Type

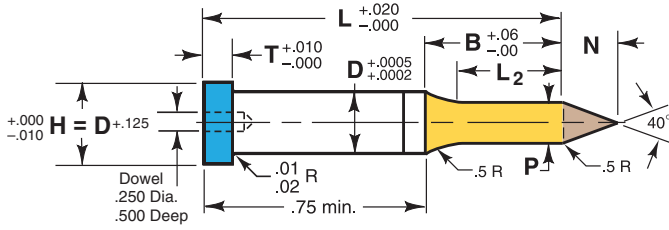

Steel: M2 Rc 60-63
Heads Rc 40-55
P +.0005
-.0000 © .0005 P to D

B & L Lengths do not include Pilot Tip N

Ordering Example: Qty Steel Type D B L P
12 M2 CDSAP 62 B x 3.00 x .562

Pilot Type	D	Std.	Alternates				Lengths L in .25" Increments	Range P +.0005 -.0000	N MAX	T
		S	B(.75)	C(1.0)	D(1.25)	E(1.5)				
CDSAP37	.3750	.625	●	●			2.50 thru 4.25	.124 - .3750	.375	.187
CDSAP50	.5000	.812	●	●			2.50 thru 5.50	.249 - .5000	.500	.187
CDSAP62	.6250	.937	●	●	●		2.50 thru 5.25	.374 - .6250	.625	.250
CDSAP75	.7500	1.062	●	●	●		2.50 thru 5.25	.499 - .7500	.750	.250
CDSAP100	1.0000	1.250	●	●	●	●	3.00 thru 5.00	.666 - 1.0000	1.000	.250

All Lengths under 4.50 OAL in Light Blue Panel have Hot Forged Heads for added strength and toughness.

PORTER Standard Center Dowel Blank Punches

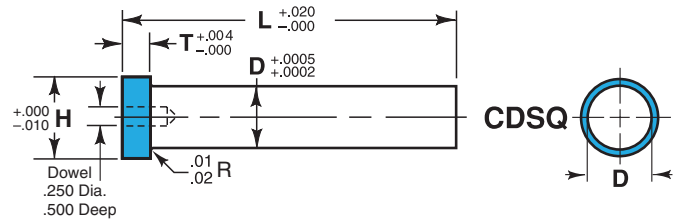
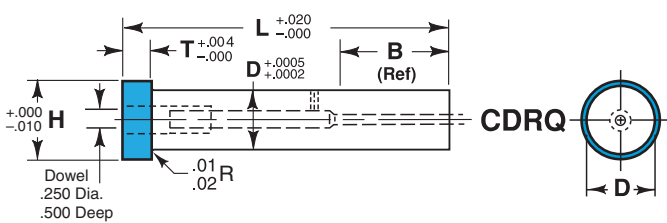

Ordering Example: Qty Steel Type D B L
6 M2 CDRQ 37 D x 2.75

Ordering Example: Qty Steel Type D L
6 M2 CDSQ 37 2.75

D	Code No.	Head		Standard	Alternates				Lengths L in .25" Increments	Retrakto Pin
		H	T	S	B(.75)	C(1.0)	D(1.25)	E(1.5)		
.3750	37	.500	.188	.625	●	●			2.00 thru 4.00	K6I
.5000	50	.625	.188	.812	●	●			2.00 thru 4.00	K6I
.6250	62	.750	.250	.937	●	●			2.25 thru 4.00	K9I
.7500	75	.875	.250	1.062	●	●	●		2.25 thru 4.00	K9I
1.0000	100	1.125	.250	1.250	●	●	●	●	2.50 thru 4.00	K9I

All Lengths under 4.50 OAL in Light Blue Panel have Hot Forged Heads for added strength and toughness.

Many longer than standard "L" are in stock. Please contact factory.

Standard Alterations are changes that are beyond the ranges listed in the catalog that can be altered for a minimal charge. See page 37.