

# PORTER Standard Headed Punches (S-)

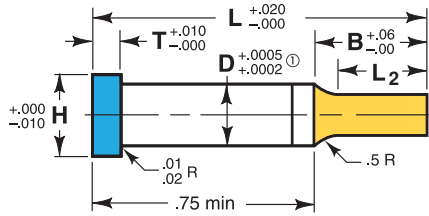

**Ordering Example:** Qty Steel Type D B L P  
13 M2 SC 50 S x 3.00 x .470

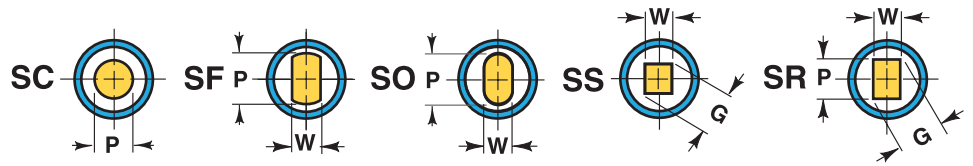

### Reflected View

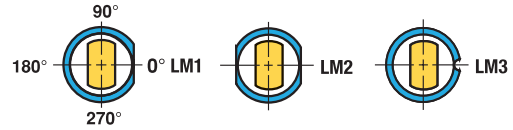

Optional Locating Methods See Page 38 for details and options.

For additional standard forms and configurations see pages 32 and 33.

Shank		Head		Point Length B				Lengths L in .25" Increments	Point		
D*	Code No.	H	T	Standard	Alternates				Round	Shape	
				S	B(.75)	C(1.0)	D(1.25)		E(1.5)	Range P	Min W Max P/G
.1250	12	.250	.125	.437	●				.062 – .1249	.062	.1250
.1875	18	.312	.125	.437	●				.062 – .1874	.062	.1875
.2500	25	.375	.125	.500	●				.062 – .2499	.062	.2500
.3125	31	.437	.125	.562	●	●			.093 – .3124	.093	.3125
.3750	37	.500	.188	.625	●	●			.125 – .3749	.125	.3750
.4375	43	.562	.188	.750	●	●			.187 – .4374	.187	.4375
.5000	50	.625	.188	.812	●	●	●		.250 – .4999	.187	.5000
.6250	62	.750	.250	.937	●	●	●		.375 – .6249	.250	.6250
.7500	75	.875	.250	1.062	●	●	●		.500 – .7499	.312	.7500
.8750	87	1.000	.250	1.125	●	●	●	●	.562 – .8749	.312	.8750
1.0000	100	1.125	.250	1.250	●	●	●	●	.625 – .9999	.312	1.0000
1.1250	112	1.250	.250	1.375	●	●	●	●	.625 – 1.1249	.312	1.1250
1.2500	125 ①	1.375	.250	1.375	●	●	●	●	.625 – 1.2499	.312	1.2500
1.3750	137 ①	1.500	.250	1.375	●	●	●	●	.719 – 1.3749	.312	1.3750
1.5000	150 ①	1.625	.250	1.375	●	●	●	●	.750 – 1.4999	.312	1.5000
1.6250	162 ①	1.750	.250	1.375	●	●	●	●	.875 – 1.6249	.350	1.6250
1.7500	175 ①	1.875	.250	1.375	●	●	●	●	1.000 – 1.7499	.350	1.7500
2.0000	200 ①	2.125	.250	1.375	●	●	●	●	1.188 – 1.9999	.400	2.0000
2.2500	225 ①	2.375	.250	1.375	●	●	●	●	1.375 – 2.2499	.450	2.2500
2.5000	250 ①	2.625	.250	1.375	●	●	●	●	1.625 – 2.4999	.500	2.5000

\*D Ø > 1.000 M-2 (HSS) Steel only. Many longer than standard "L" are in stock. Please request quote for these items.

All Lengths under 4.50 in Light Blue Panel have Hot Forged Heads for added strength and toughness.

# PORTER Standard Head Punch Blanks (SQ)

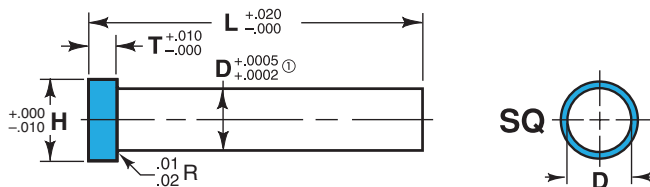

**Ordering Example:** Qty Steel Type D L  
13 M2 SQ 25 x 2.00

Steel: A2 L ≤ 4", M2 Rc 60-63  
Heads Rc 40-55 (1" Ø and smaller and L ≥ 2")

### TOLERANCES

Round P  $\begin{matrix} +.0005 \\ -.0000 \end{matrix}$  © .0005 P to D  
Shape P, W ±.0005 © .001 P,W to D

Manufactured to ANSI and NAPMA Standards where applicable.

① D Tol =  $\begin{matrix} +.0006 \\ +.0002 \end{matrix}$

Back Draft .001/inch L<sub>2</sub> max.

Standard Alterations are changes that are beyond the ranges listed in the catalog that can be altered for a minimal charge. See page 37.