

Ordering Example:

Qty Steel Type Code L₂/L W P
 12 M2 HBS 013 2590 9.95 x 9.95

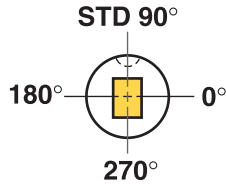

Standard ball seat location is at 90° using reflected view for punches. Alternate locations of 0°, 180° and 270° are available at no extra charge. Custom ball seat locations can be specified as number of degrees counterclockwise from 0° Example call out: BS 180°

Steel: M2 Rc 60-63

TOLERANCES

Round P $\begin{matrix} +0.01 \\ -0.00 \end{matrix}$ ⊙ 0.01 P to D

Shape P, W ± 0.01 ⊙ 0.02 P, W to D

Manufactured to ISO and NAPMA standards where applicable.
 Back Draft 0.1/100mm L₂ max.

Shank		Point Length L ₂			Lengths L							Point		Replacement Retracto Kit*
D	Code	Std.	Alt.	Alt.	63	71	80	90	100	110	125	Round Range P	Shape Min W Max P/G	
10	010	19	10		●	●	●	●	●			2.10 – 9.97	2.10 9.97	K3M/K4M**
13	013	19	13	25	◆	●	●	●	●	●	●	5.00 – 12.97	4.50 12.97	K6M
16	016	19	13	25	◆	●	●	●	●	●	●	8.00 – 15.97	6.00 15.97	K6M
20	020	19	13	25	◆	●	●	●	●	●	●	12.00 – 19.97	8.00 19.97	K9M
25	025	19	13	25		●	●	●	●	●	●	16.00 – 24.97	10.00 24.97	K9M
32	032	19	13	25		●	●	●	●	●	●	24.00 – 31.97	12.50 31.97	K12M
40	040	25	19	30			●	●	●	●	●	30.00 – 39.97	14.00 39.97	K12M

◆ = L₂, 25 not available 32 mm Ø + larger = no side hole. *Retrakto Kits available see page 36 for details. **K3M (P<3.0)

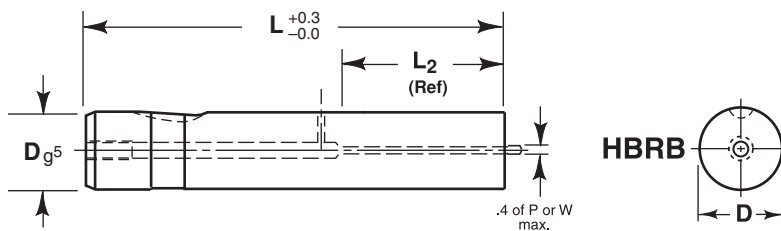

Ordering Example:

Qty Steel Type Code L₂/L
 25 M2 HBB 025 1380

Shank		Point Length L ₂			Lengths L							Replacement Retracto Kit*
D	Code	Std.	Alt.	Alt.	63	71	80	90	100	110	125	
10	010	19	10		●	●	●	●	●			K3M/K4M
13	013	19	13	25	◆	●	●	●	●	●	●	K6M
16	016	19	13	25	◆	●	●	●	●	●	●	K6M
20	020	19	13	25	◆	●	●	●	●	●	●	K9M
25	025	19	13	25		●	●	●	●	●	●	K9M
32	032	19	13	25		●	●	●	●	●	●	K12M
40	040	25	19	30			●	●	●	●	●	K12M

◆ = L₂, 25 not available. 32 mm Ø + larger = no side hole. *Retrakto Kits available see page 36 for details.