

Ordering Example: Qty Steel Type Code L₂/L P
13 M2 RC 013 1960 x 10.50

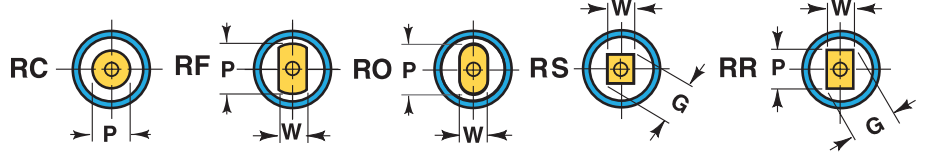

For additional standard forms and configurations see pages 32 and 33.

Reflected View

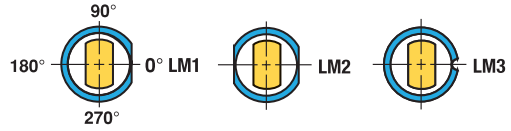

Optional Locating Methods See Page 38 for details and options.

Shank		Head		L ₂		Lengths L									Point		Replacement Retrako® Kit*		
D mm	Code No.	H	T	Std.	Alt.	45	50	56	60	63	70	71	80	90	100	Round Range P		Shape	
																		Min W	Max P/G
5	005	8	5	13	19	◆	●	●	●	●	●	●	●	●	●	1.60 – 4.99	1.60	5.00	K2M
6	006	9	5	13	19	◆	●	●	●	●	●	●	●	●	●	2.40 – 5.99	2.40	6.00	K3M
8	008	11	5	19	25		◆	●	●	●	●	●	●	●	●	3.20 – 7.99	3.20	8.00	K4M
10	010	13	5	19	25		◆	●	●	●	●	●	●	●	●	4.50 – 9.99	4.50	10.00	K6M
13	013	16	5	19	25		◆	●	●	●	●	●	●	●	●	6.00 – 12.99	6.00	13.00	K6M
16	016	19	5	19	25		◆	●	●	●	●	●	●	●	●	8.00 – 15.99	7.20	16.00	K9M
20	020	23	5	19	25		◆	●	●	●	●	●	●	●	●	10.00 – 19.99	8.00	20.00	K9M
25	025	28	5	19	25		◆	●	●	●	●	●	●	●	●	12.00 – 24.99	9.00	25.00	K9M
32	032	35	5	25	30					◆	●	●	●	●	●	16.00 – 31.99	10.00	32.00	K12M
40	040	43	5	25	30					◆	●	●	●	●	●	20.00 – 39.99	10.00	40.00	K12M
45	045	48	5	25	30					◆	●	●	●	●	●	25.00 – 44.99	10.00	45.00	K12M
50	050	53	5	25	30					◆	●	●	●	●	●	30.00 – 49.99	10.00	50.00	K12M
56	056	59	5	25	30					◆	●	●	●	●	●	35.00 – 55.99	11.00	56.00	K12M
63	063	66	5	25	30					◆	●	●	●	●	●	40.00 – 62.99	12.00	63.00	K12M

◆ Only available in Standard Point Length. *Retrako Kits available see page 36 for details
5 mm Ø + 32 mm Ø + larger = no side hole.

All Lengths in Light Blue Panel have Hot Forged Heads for added strength and toughness.

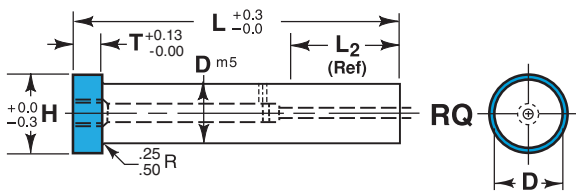

Ordering Example: Qty Steel Type Code L₂/L
13 M2 RQ 010 1980

Standard Alterations are changes that are beyond the ranges listed in the catalog that can be altered for a minimal charge. See page 37.

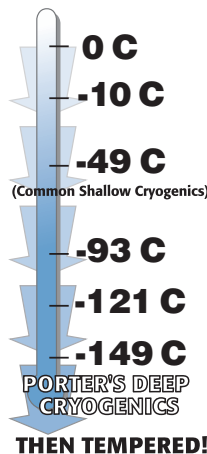

All Porter Standard Punches up to 25mm Dia. are "Deep Cryogenically" treated for
1. Wear
2. Toughness
3. Dimensional Stability
See page 42 for more details.

Steel: D2, M2, Rc 60-63
Heads Rc 40-55 (25mm Ø and smaller and L ≥ 50)

TOLERANCES

Round P $\begin{matrix} +0.01 \\ -0.00 \end{matrix}$ ⊙ 0.01 P to D

Shape P, W ± 0.01 ⊙ 0.02 P, W to D

Manufactured to ISO and NAPMA standards where applicable.
Back Draft 0.1/100mm L₂ max.