

PORTER Standard Taper Relief Headed Die Buttons (HDT-)

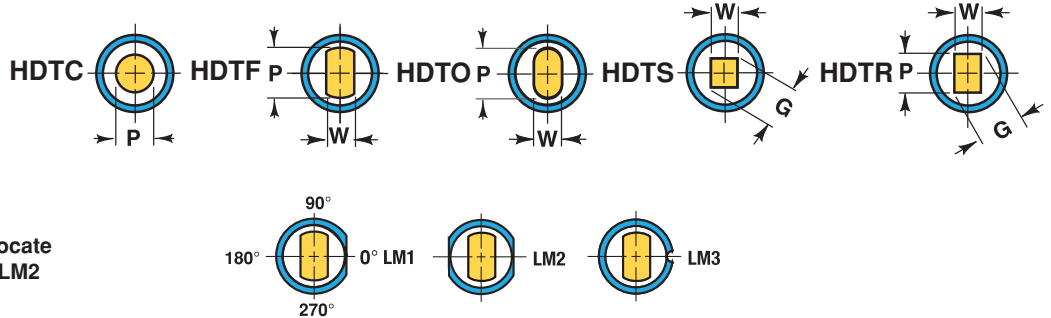
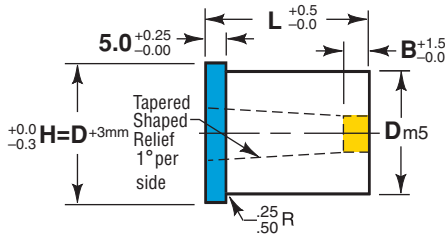

Ordering Example:

Qty Steel Type Code/B L W P Locate
 5 M2 HDTS 025A 30 x 4.00 x 4.00 LM2

Optional Locating Methods See Page 38 for details and options.

Body D	Code No.	B			Lengths L										Range P	Min. W	Max. P/G	
		Std S	Alt A	Alt B	L													
					13	16	19	20	22	25	28	30	32	35				
5.0	005	4	5	3	●	●	●	●	●	●	●	●	●	●	●	1.30 – 3.20	1.30	3.20
6.0	006	4	5	3	●	●	●	●	●	●	●	●	●	●	●	1.30 – 3.90	1.30	3.90
8.0	008	4	5	3	●	●	●	●	●	●	●	●	●	●	●	1.30 – 5.40	1.30	5.40
10.0	010	4	5	3	●	●	●	●	●	●	●	●	●	●	●	1.60 – 6.80	1.30	6.80
13.0	013	5	8	3	●	●	●	●	●	●	●	●	●	●	●	3.00 – 8.80	1.90	8.80
16.0	016	5	8	3			●	●	●	●	●	●	●	●	●	7.40 – 10.80	1.90	10.80
20.0	020	5	10	3			●	●	●	●	●	●	●	●	●	9.50 – 13.60	1.90	13.60
22.0	022	6	10	3			●	●	●	●	●	●	●	●	●	10.50 – 15.00	1.90	15.00
25.0	025	6	10	3			●	●	●	●	●	●	●	●	●	12.00 – 17.00	1.90	17.00
32.0	032	6	12	3			●	●	●	●	●	●	●	●	●	16.00 – 22.00	4.00	22.00
38.0	038	6	12	3			●	●	●	●	●	●	●	●	●	18.00 – 27.00	4.00	27.00
40.0	040	8	12	3			●	●	●	●	●	●	●	●	●	18.00 – 27.00	4.00	27.00
45.0	045	8	12	3					D	D	D	D	D	D	D	18.00 – 35.00	4.00	35.00
50.0	050	8	12	3					D	D	D	D	D	D	D	18.00 – 40.00	4.00	40.00
56.0	056	8	12	3					D	D	D	D	D	D	D	18.00 – 45.00	4.00	45.00
63.0	063	8	12	3					D	D	D	D	D	D	D	18.00 – 50.00	4.00	50.00
71.0	071	8	12	3					D	D	D	D	D	D	D	18.00 – 56.00	4.00	56.00
76.0	076	8	12	3					D	D	D	D	D	D	D	25.00 – 60.00	5.60	60.00

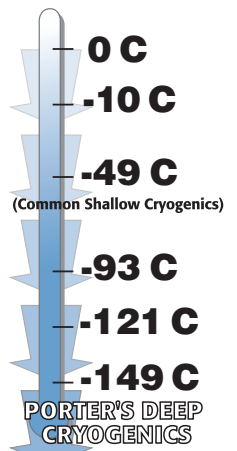

THEN TEMPERED!
 All Porter Standard Taper Die Buttons are "Deep Cryogenically" treated for
 1. Wear
 2. Toughness
 3. Dimensional Stability
 See page 42 for details.

● Available Both HDT & DT D Available in DT only

PORTER Standard Taper Relief Headless Die Buttons (DT-)

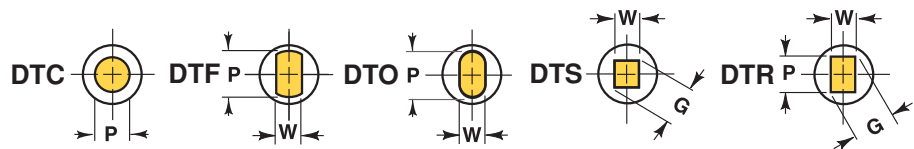
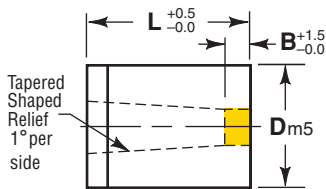

Ordering Example:

Qty Steel Type Code/B L P
 10 M2 DTC 050B x 40 x 20.00



Optional Locating Methods See Page 38 for details and options.

Steel: M2 Rc 60-63
TOLERANCES
 Round P $\begin{matrix} +0.01 \\ -0.00 \end{matrix}$ Ⓞ 0.01 P to D
 Shape P, W ± 0.01 Ⓞ 0.02 P,W to D
 Manufactured to ISO and NAPMA standards where applicable.

Standard Alterations are changes that are beyond the ranges listed in the catalog that can be altered for a minimal charge. See page 37.

For additional standard forms and configurations see pages 32 and 33.