

Steel: M2 Rc 60-63
TOLERANCES
 P ±.13 Ⓞ .13 P to D
 ① ØD > 40 Tol. D = m5

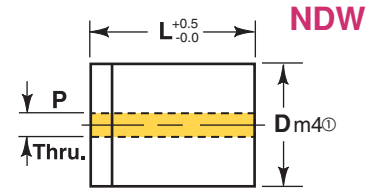

Ordering Example: Qty Type Code L
 8 HNDW 025 x 32

Ordering Example: Qty Type Code L
 6 NDW 016 x 25

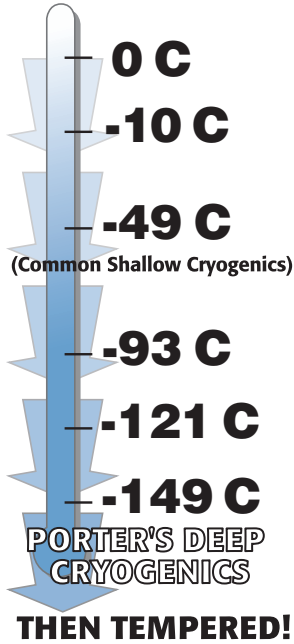

All Porter Wire Blanks are "Deep Cryogenically" treated for
 1. Wear
 2. Toughness
 3. Dimensional Stability
 See page 42 for more details.

Body		Lengths L										P Thru Hole
D	Code	13	16	19	20	22	25	28	30	32	35	
5	005	●	●	●	●	●	●	●	●	●	●	0.8
6	006	●	●	●	●	●	●	●	●	●	●	0.8
8	008	●	●	●	●	●	●	●	●	●	●	0.8
10	010	●	●	●	●	●	●	●	●	●	●	0.8
13	013	●	●	●	●	●	●	●	●	●	●	1.6
16	016			●	●	●	●	●	●	●	●	1.6 & 3.0
20	020			●	●	●	●	●	●	●	●	1.6 & 3.0
22	022			●	●	●	●	●	●	●	●	1.6
25	025			●	●	●	●	●	●	●	●	1.6 & 3.0
32	032			●	●	●	●	●	●	●	●	3.5
38	038				●	●	●	●	●	●	●	1.6
40	040				●	●	●	●	●	●	●	3.2
45	045					N	N	N	N	N	N	3.2
50	050					N	N	N	N	N	N	3.2
56	056					N	N	N	N	N	N	3.2
63	063					N	N	N	N	N	N	3.2
71	071					N	N	N	N	N	N	3.2
76	076					N	N	N	N	N	N	3.2

● Available HNDW & NDW N = Available in NDW only

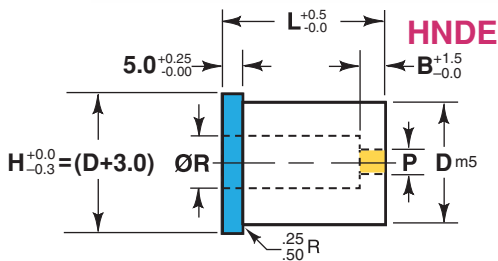

Steel: M2 Rc 60-63
TOLERANCES
 ØP ±.13 Ⓞ .13 P to D

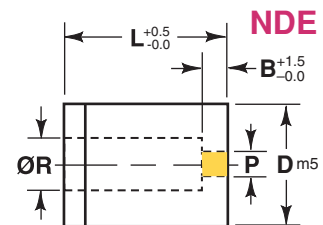

Ordering Example: Qty Type Code L
 8 HNDE 025 x 30

Ordering Example: Qty Type Code L
 6 NDE 016 x 30

Body		Lengths L										Flush Hole		Relief
D	Code	13	16	19	20	22	25	28	30	32	35	P	B	ØR
8	008	●	●	●	●	●	●	●	●	●	●	0.8 & 2.35	4.0	4.0
10	010	●	●	●	●	●	●	●	●	●	●	0.8 & 2.35	4.0	6.0
13	013	●	●	●	●	●	●	●	●	●	●	1.6 & 3.0	5.0	8.0
16	016			●	●	●	●	●	●	●	●	1.6 & 3.5	5.0	9.5
20	020			●	●	●	●	●	●	●	●	1.6 & 3.5	5.0	12.0
22	022			●	●	●	●	●	●	●	●	1.6 & 3.5	6.0	15.0
25	025			●	●	●	●	●	●	●	●	1.6 & 4.0	6.0	17.5
32	032			●	●	●	●	●	●	●	●	1.6 & 3.0	6.0	21.0
38	038				●	●	●	●	●	●	●	2.5	6.0	27.0

Standard Alterations are changes that are beyond the ranges listed in the catalog that can be altered for a minimal charge. See page 37.